



Conprofe Lightweight Vertical 5-Axis Machining Center

The information given is not binding. The actual product and mutual agreement shall prevail.

20241023 VE1.6

Conprofe Machine Tool Co., Ltd. // Wholly-Owned Subsidiary of Conprofe Technology Group Co., Ltd.

Contact: Esther HU +86-138 2607 9999

E-mail: esther.hu@conprofetech.com

Web: www.conprofecnc.com

Address: No.6 2nd Nanyun Road, Science City, Hi-tech Development Zone, Guangzhou, 510663, P.R.C



Website



Direct Industry



LinkedIn

Lightweight Vertical 5-Axis Machining Center

LVD100-5AXIS



Technical Data

Controller

CNC Controller	-	M30
----------------	---	-----

Spindle

Diameter	mm	Φ80
Max. Speed (Short-Duration)	rpm	40,000
Max. Speed (Long-Duration)	rpm	28,000
Tool Spec.	mm	Φ6
Motor Power	kW	4
Ultrasonic	-	/
Minimum Quantity Lubrication (MQL)	-	/
Ultrasonic + MQL	-	/

Tool Magazine

Tool Holding Capacity	No. of Tools	20
Max. Tool Diameter (Full)	mm	Φ6
Max. Tool Length	mm	55
Max. Tool Weight	kg	0.5
Type	-	Built-in Type

Miscellaneous

Power Supply Voltage	-	Three-Phase AC, 380V/50Hz
Power Capacity	kVA	8.5
Air Pressure	MPa	0.4-0.7
Total Air Consumption	L/min	5-300
Total Weight (incl. Accessories)	kg	790
Machine Size (LxWxH)	mm	1,010x1,120x1,940

Travel

X/Y/Z-Axis Travel	mm	340x100x120
A/B-Axis Swivel Range	°	360° / ±125°

Worktable

Dimensions	mm	Φ100
Max. Load	kg	5
Max. Workpiece Size	mm	Φ90x30

Feed Rate

X/Y/Z-Axis Rapid Speed	m/min	10/10/10
A/B-Axis Rapid Speed	rpm	60/40

Accuracy

X/Y/Z-Axis Positioning Accuracy	mm	0.005
X/Y/Z-Axis Repeatability	mm	0.003
A/B-Axis Positioning Accuracy	"	≤40
A/B-Axis Repeatability	"	≤8
Accuracy Grade	-	P

Standard Configurations

Direct-Tool-Clamping Spindle (4kW)	Spindle Chiller
20T Magazine	Manual Lubrication System
Coolant System	Automatic Door

Optional Configurations

- Optional Fixture for Disc-Shape Blanks (Malone Bridge, Crown)
- Optional Automatic Storage & Access System for Pre-Milled Titanium Blanks
- Optional Automatic Storage & Access System for Pre-Milled Crowns
- Optional Automatic Storage & Access System for Pre-Milled Titanium Blanks & Crowns

Floor Plans (Unit: mm)

Front View

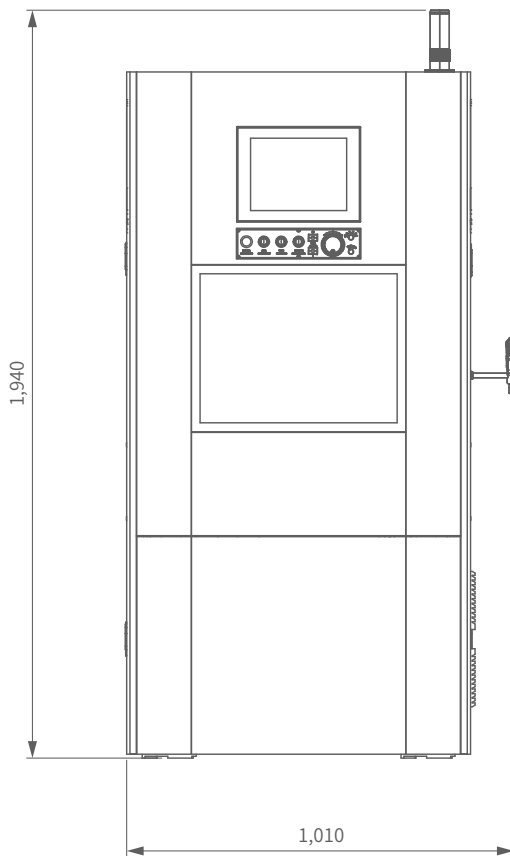

Side View

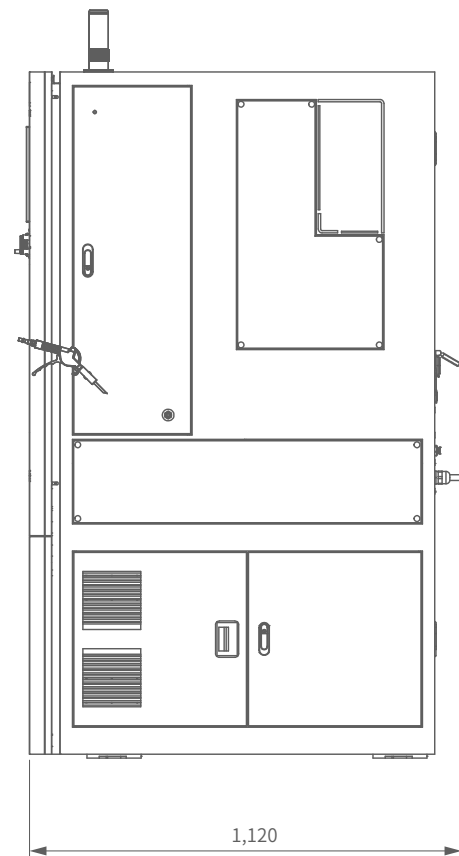

The information given is not binding. The actual product and mutual agreement shall prevail.

Contact: Esther HU +86-138 2607 9999

E-mail: esther.hu@conprofotech.com

Address: No.6 2nd Nanyun Road, Science City, Hi-tech Development Zone, Guangzhou, 510663, P.R.C

LVD100-5AXIS 20241023 VE1.6

Lightweight Ultrasonic-Green

Vertical 5-Axis Machining Center

UGV100L-5AXIS



Technical Data

Controller

CNC Controller	-	M30
----------------	---	-----

Spindle

Diameter	mm	Φ80
Max. Speed (Short-Duration)	rpm	36,000
Max. Speed (Long-Duration)	rpm	24,000
Spindle Taper	-	HSK-E25
Motor Power	kW	3.7
Ultrasonic	-	Standard
Minimum Quantity Lubrication (MQL)	-	Optional
Ultrasonic + MQL	-	Optional

Tool Magazine

Tool Holding Capacity	No. of Tools	10
Max. Tool Diameter (Full)	mm	Φ10
Max. Tool Length	mm	55
Max. Tool Weight	kg	0.5
Type	-	Built-in Type

Miscellaneous

Power Supply Voltage	-	Three-Phase AC, 380V/50Hz
Power Capacity	kVA	9
Air Pressure	MPa	0.4-0.7
Total Air Consumption	L/min	5-600
Total Weight (incl. Accessories)	kg	790
Machine Size (LxWxH)	mm	1,010×1,120×1,940

Travel

X/Y/Z-Axis Travel	mm	340×100×120
A/B-Axis Swivel Range	°	360° /±125°

Worktable

Dimensions	mm	Φ100
Max. Load	kg	5
Max. Workpiece Size	mm	Φ90×30

Feed Rate

X/Y/Z-Axis Rapid Speed	m/min	12/12/12
A/B-Axis Rapid Speed	rpm	60/40

Accuracy

X/Y/Z-Axis Positioning Accuracy	mm	0.005
X/Y/Z-Axis Repeatability	mm	0.003
A/B-Axis Positioning Accuracy	"	≤40
A/B-Axis Repeatability	"	≤8
Accuracy Grade	-	P

Standard Configurations

- Ultrasonic Spindle HSK-E25 (3.7kW)
- 10T Disc-Type Tool Magazine
- Coolant System
- Constant Temperature Spindle Chiller
- Automatic Quantitative Oil Injection System
- Automatic Door
- Ultrasonic Machining System
- Electronic Cabinet Cooling System
- Incl. 3 Tool Holders

Optional Configurations

- Optional Fixture for Disc-Shape Blanks (Malone Bridge, Crown)
- Optional Automatic Storage & Access System for Pre-Milled Titanium Blanks
- Optional Automatic Storage & Access System for Pre-Milled Crowns
- Optional Automatic Storage & Access System for Pre-Milled Titanium Blanks & Crowns
- Cut-Off and Collection System (Abutments/Dental Crowns)
- Through-Spindle Cooling Unit
- Minimum Quantity Lubrication (MQL) System
- 18T Disc-Type Tool Magazine

Floor Plans (Unit: mm)

Front View

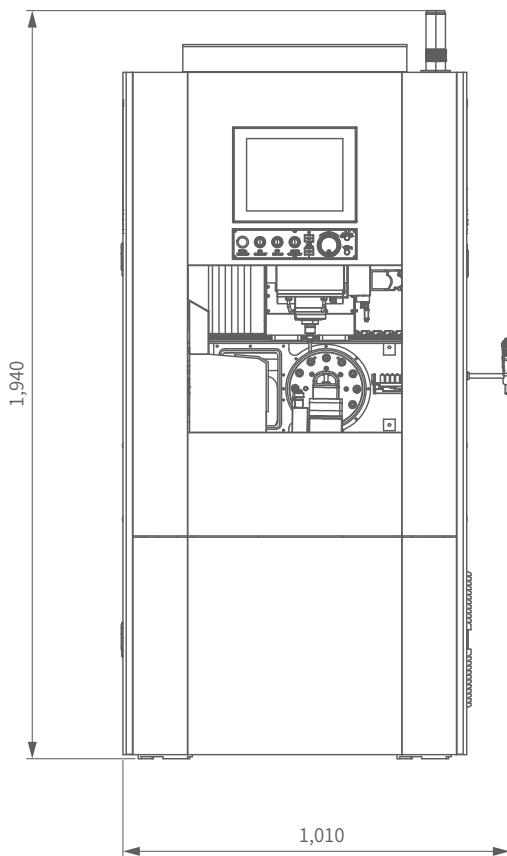

Side View

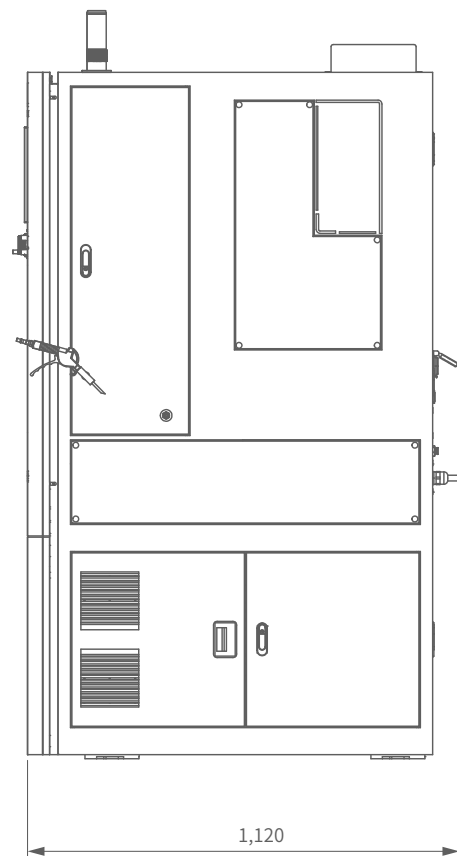

The information given is not binding. The actual product and mutual agreement shall prevail.

Contact: Esther HU +86-138 2607 9999

E-mail: esther.hu@conprofotech.com

Address: No.6 2nd Nanyun Road, Science City, Hi-tech Development Zone, Guangzhou, 510663, P.R.C

UGV100L-5AXIS 20241023 VE1.6

CONPROFE

CONverging of Global Resources
PROFEssional as Industry Leader



Conprofe Technology Group Co., Ltd.

Website: www.conprofecnc.com

E-mail: sales-international@conprofetech.com

Tel: +86-20 3861 9084 / +86-138 2607 9999

Address: No.6, 2nd Nanyun Road, Science City, Hi-tech
Development Zone, Guangzhou, 510663, P.R.C



Website



YouTube



LinkedIn

© 2024 Conprofe Technology Group Co., Ltd. All Rights Reserved.