

Ultrasonic-Green

Vertical Machining Center

UGV-500



Technical Data

Controller

CNC Controller	Mitsubishi M80A
----------------	-----------------

Spindle

Diameter	mm	Φ140	Φ150 (Optional)
Max. Speed (Short-Duration)	rpm	15000 (Direct-Driven)	20000 (Electric Spindle)
Max. Speed (Long-Duration)	rpm	12000 (Direct-Driven)	16000 (Electric Spindle)
Motor Power (Rated / Short-Duration)	kW	5.5	9/15
Motor Torque (Rated / Short-Duration)	Nm	17.5	14.8/6
Spindle Taper	-	BT40	HSK-A63
Ultrasonic	-	Optional	Optional
Minimum Quantity Lubrication (MQL)	-	Optional	Optional
Ultrasonic + MQL	-	Optional	Optional

Tool Magazine

Tool Holding Capacity	No. of Tools	24 (Standard)	30 (Optional)
Max. Tool Diameter (Full / Partial)	mm	Φ75/Φ150	
Max. Tool Length	mm	300	
Max. Tool Weight	kg	8	
Type	-	Disc Type	

Miscellaneous

Power Supply Voltage	-	Three-Phase AC,	
		380V/50Hz	
Power Capacity	kVA	18	20
Air Pressure	MPa	0.5-0.7	
Total Air Consumption	L/min	>100	
Total Weight (incl. Accessories)	kg	3800	
Machine Size (L x W x H)	mm	2120×2380×2850	

Travel

X/Y/Z-Axis Travel	mm	550/400/450
Spindle Nose to Table	mm	140-590
Spindle Center to Column Guide	mm	409

Worktable

Dimensions	mm	650×400
Max. Load	kg	300
T-Slot (No. x Width x Distance)	pcs×mm×mm	3×14×110

Feed Rate

X/Y/Z-Axis Rapid Speed	m/min.	48/48/48
X/Y/Z-Axis Max. Feed Rate	m/min.	10/10/10
X/Y/Z-Axis Motor Power	kW	1.5/1.5/3.0

Accuracy

X/Y/Z-Axis Positioning Accuracy	mm	0.006
X/Y/Z-Axis Repeatability	mm	0.003
Accuracy Grade	-	UP

Standard Configurations

Coolant System	Electrical Cabinet Heat Exchanger
Automatic Centralized Lubrication System	LED Work Light
Handwheel	Three-Color Alarm Light
Blow Gun	Door Safety Interlock

Optional Configuration

Oil-Mist Collector	Disc-Type Oil-Water Separator
4/5th Axis Rotary Table	Spindle Chiller
Contact Tool Setter	Chip Conveyor
High Precision 3D Probe	Water Gun
Automatic Door	

Floor Plans (Unit: mm)

Front View

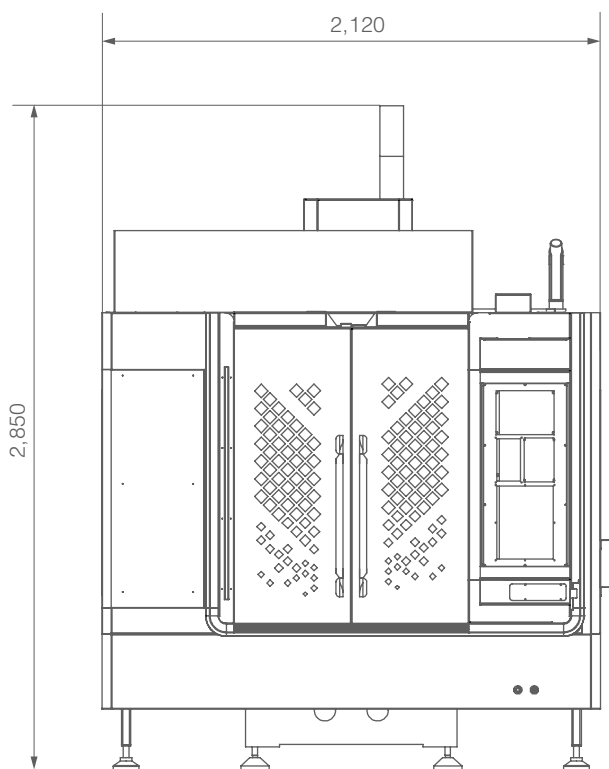

Top View

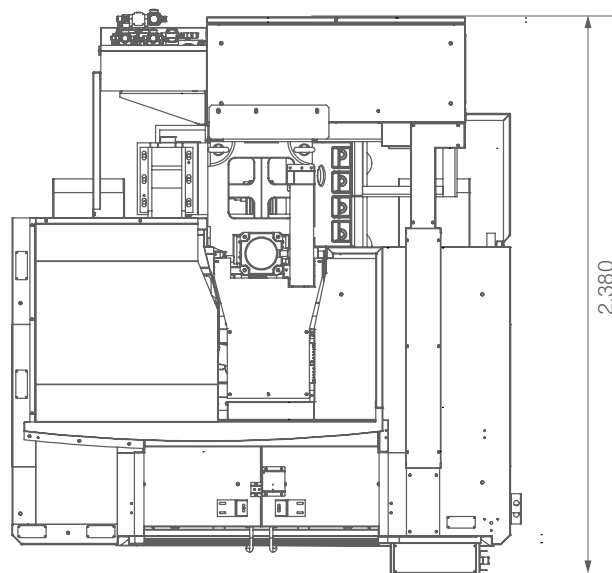

The information given is not binding. The actual product and mutual agreement shall prevail.

Contact: Esther HU +86-138 2607 9999

E-mail: esther.hu@conprofotech.com

Address: No.6 2nd Nanyun Road, Science City, Hi-tech Development Zone, Guangzhou, 510663, P.R.C

UGV-500 20231124 VE1.2