

# Ultrasonic-Green

## Vertical Machining Center

# UGV-856



## Technical Data

### Controller

	Standard
CNC Controller	Mitsubishi M80B

### Spindle

Diameter	mm	Φ140	Φ150
Max. Speed (Short-Duration)	rpm	15000 (Direct-Driven)	20000 (Electric Spindle)
Max. Speed (Long-Duration)	rpm	12000 (Direct-Driven)	15000 (Direct-Driven)
Motor Power (Rated / Short-Duration)	kW	5.5/7.5	5.5/7.5
Motor Torque (Rated / Short-Duration)	Nm	35/47.7	35/47.7
Spindle Taper	-	BT40	BT40
Ultrasonic	-	Optional	Optional
Minimum Quantity Lubrication (MQL)	-	Optional	Optional
Ultrasonic + MQL	-	Optional	Optional

### Tool Magazine

Tool Holding Capacity	No. of Tools	24 (Standard)	30 (Optional)
Max. Tool Diameter (Full / Partial)	mm	Φ78/Φ120	
Max. Tool Length	mm	300	
Max. Tool Weight	kg	8	
Type	-	Disc Type	

### Miscellaneous

Power Supply Voltage	-	Three-Phase AC, 380V/50Hz
Power Capacity	kVA	20
Air Pressure	MPa	0.5-0.7
Total Air Consumption	L/min	>100
Total Weight (incl. Accessories)	kg	5500
Machine Size (L x W x H)	mm	2350×2950×2550

### Travel

X/Y/Z-Axis Travel	mm	800×550×600
Spindle Nose to Table	mm	130-730
Spindle Center to Column Guide	mm	575

### Worktable

Dimensions	mm	1000×500
Max. Load	kg	450
T-Slot (No. x Width x Distance)	pcs×mm×mm	4×18×124

### Feed Rate

X/Y/Z-Axis Rapid Speed	m/min.	48/48/32
X/Y/Z-Axis Max. Feed Rate	m/min.	10/10/10
X/Y/Z-Axis Motor Power	kW	2/2/3

### Accuracy

X/Y/Z-Axis Positioning Accuracy	mm	0.006
X/Y/Z-Axis Repeatability	mm	0.004
Accuracy Grade	-	UP

## Standard Configurations

Coolant System	Electrical Cabinet Heat Exchanger
Automatic Centralized Lubrication System	LED Work Light
Handwheel	Three-Color Alarm Light
Blow Gun	Door Safety Interlock

## Optional Configurations

Oil-Mist Collector	Disc-Type Oil-Water Separator
4/5th Axis Rotary Table	Spindle Chiller
Contact Tool Setter	Chip Conveyor
High Precision 3D Probe	Water Gun
Automatic Door	

## Floor Plans (Unit: mm)

### Front View

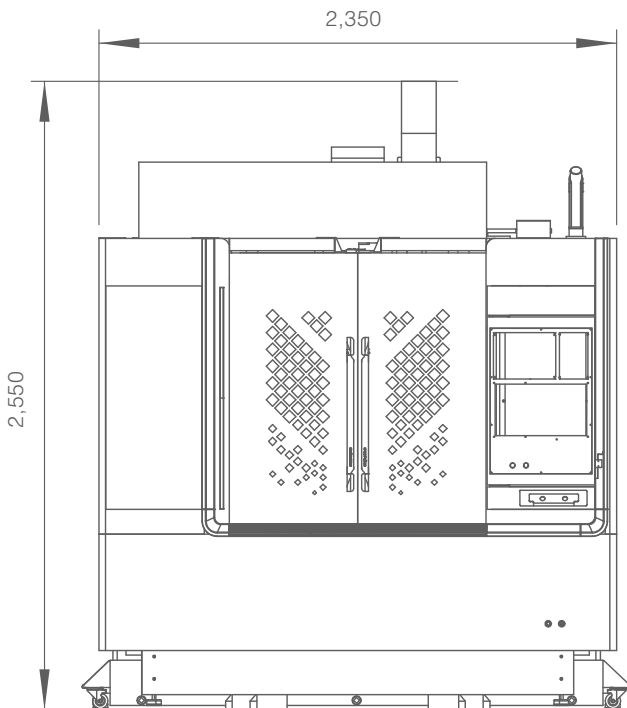

### Top View

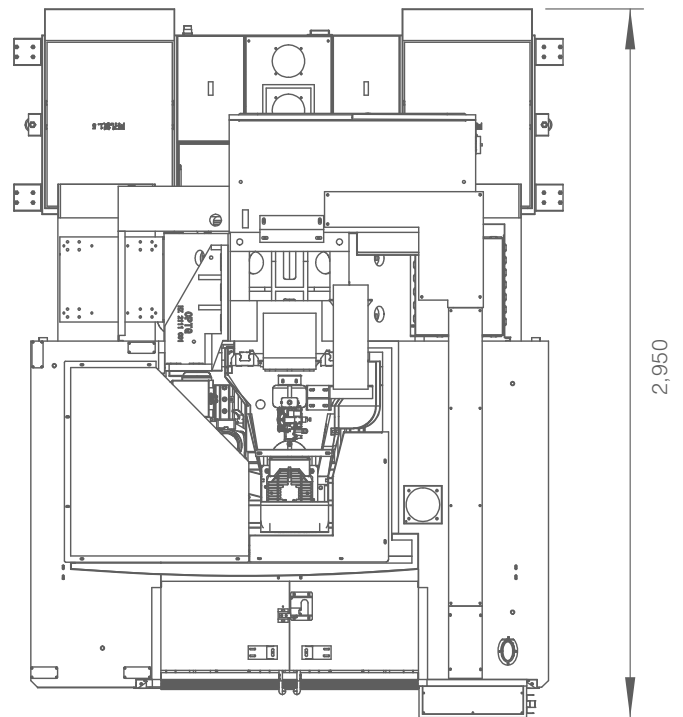

The information given is not binding. The actual product and mutual agreement shall prevail.

Contact: Esther HU +86-138 2607 9999

E-mail: [esther.hu@conprofotech.com](mailto:esther.hu@conprofotech.com)

Address: No.6 2nd Nanyun Road, Science City, Hi-tech Development Zone, Guangzhou, 510663, P.R.C

UGV-856 20231124 VE3.1