

# Conprofe Graphite Machining Centers



**UPG Series**



## Technical Parameters



Item	Unit	UPG-500B	UPG-600C
<b>Travel</b>			
X/Y/Z-Axis Travel	mm	500×400×230	600×500×250
Spindle Nose to Table	mm	165-395	150-400
<b>Worktable</b>			
Dimensions	mm	500×400	620×560
Max. Load	kg	200	200
T-Slot (No.×Width×Distance)	pcs×mm×mm	4×12×100	7×12×80
<b>Spindle</b>			
Diameter	mm	Φ 120	Φ 150
Max. Speed (Short-Duration)	rpm	30,000	18,000
Max. Speed (Long-Duration)	rpm	24,000	14,400
Motor Power (Rated)	kW	7.5	Y:15 Δ:20
Motor Torque (Rated)	Nm	3.4	Y:39.6 Δ:24.8
Spindle Taper	-	HSK-E40	HSK-A63
Ultrasonic	-	Optional	Optional
<b>Feed Rate</b>			
X/Y/Z-Axis Rapid Speed	m/min	15/15/15	15/15/15
X/Y/Z-Axis Max. Feed	m/min	10/10/10	10/10/10
X/Y/Z-Axis Motor Power	kW	0.8/0.8/0.8	0.85/0.85/0.85
<b>Accuracy</b>			
X/Y/Z-Axis Positioning Accuracy	mm	0.003	0.003
X/Y/Z-Axis Repeatability	mm	0.002	0.002
<b>Tool Magazine</b>			
Tool Holding Capacity	No. of Tools	12	9
Max. Tool Diameter (Full)	mm	90	110
Max. Tool Length	mm	90	70
Max. Tool Weight	kg	3	3
Type	-	Umbrella Type	Umbrella Type
<b>Miscellaneous</b>			
Power Supply Voltage	-	Three-Phase AC, 380V/50Hz	Three-Phase AC, 380V/50Hz
Power Capacity	kVA	12	27
Air Pressure	MPa	0.5-0.7	0.5-0.7
Total Air Consumption	L/min	>100	>100
Total Weight (incl. Accessories)	kg	3,500	5,000
Machine Size (L×W×H)	mm	1,805×1,890×2,350	1,950×2,100×2,390
<b>Controller</b>			
CNC Controller	-	SIEMENS 828D-280 (Standard) HNC 918D (Optional)	HNC 918D (Standard) SIEMENS 828D-280 (Optional)

## Technical Parameters

Item	Unit	UPG-800C	UPG-1200C	UPG-1700C
<b>Travel</b>				
X/Y/Z-Axis Travel	mm	800×800×350	800×1,200×350	1,700×1,200×300
Spindle Nose to Table	mm	150-500	145-495	145-495
<b>Worktable</b>				
Dimensions	mm	850×850	850×1,250	1,700×1,200
Max. Load	kg	1,000	1,000	1,500
T-Slot (No.×Width×Distance)	pcs×mm×mm	8×18×100	8×18×100	9×18×125
<b>Spindle</b>				
Diameter	mm	Φ 150	Φ 150	Φ 150
Max. Speed (Short-Duration)	rpm	18,000	18,000	18,000
Max. Speed (Long-Duration)	rpm	14,400	14,400	14,400
Motor Power (Rated)	kW	Y:15 △:20	Y:15 △:20	Y:15 △:20
Motor Torque (Rated)	Nm	Y:39.6 △:24.8	Y:39.6 △:24.8	Y:39.6 △:24.8
Spindle Taper	-	HSK-A63	HSK-A63	HSK-A63
Ultrasonic	-	Optional	Optional	Optional
<b>Feed Rate</b>				
X/Y/Z-Axis Rapid Speed	m/min	24/24/24	24/24/24	15/15/24
X/Y/Z-Max. Feed Rate	m/min	10/10/10	10/10/10	10/10/10
X/Y/Z-Axis Motor Power	kW	3.1/3.1/3.1	3.1/4.3/3.1	3.1/4.3/3.1
<b>Accuracy</b>				
X/Y/Z-Axis Positioning Accuracy	mm	0.003	0.003	0.003
X/Y/Z-Axis Repeatability	mm	0.002	0.002	0.002
<b>Tool Magazine</b>				
Tool Holding Capacity	No. of Tools	Non-Ultrasonic: 40	Non-Ultrasonic: 40	Non-Ultrasonic: 40
		Ultrasonic: 20	Ultrasonic: 20	Ultrasonic: 20
Max. Tool Diameter (Full)	mm	76	76	76
Max. Tool Length	mm	260	260	260
Max. Tool Weight	kg	5	5	5
Type	-	Chain Type	Chain Type	Chain Type
<b>Miscellaneous</b>				
Power Supply Voltage	-	Three-Phase AC, 380V/50Hz	Three-Phase AC, 380V/50Hz	Three-Phase AC, 380V/50Hz
Power Capacity	kVA	33	33	33
Air Pressure	MPa	0.5-0.7	0.5-0.7	0.5-0.7
Total Air Consumption	L/min	>100	>100	>100
Total Weight (incl. Accessories)	kg	9,000	11,000	13,000
Machine Size (L×W×H)	mm	2,990×2,935×2,875	2,990×3,770×2,900	4,660×3,350×2,910
<b>Controller</b>				
CNC Controller	-	SIEMENS 828D-280	SIEMENS 828D-280	SIEMENS 828D-280

# Main Configurations

● Yes ○ No

	UPG-500B	UPG-600C	UPG-800C	UPG-1200C	UPG-1700C
<b>Standard Configurations</b>					
Centralized Automatic Lubrication System	●	●	●	●	●
Spindle Chiller	●	●	●	●	●
Handwheel	●	●	●	●	●
Blow Gun	●	●	●	●	●
Electrical Cabinet Heat Exchanger	●	●	●	●	●
LED Work Light	●	●	●	●	●
Three-Color Alarm Light	●	●	●	●	●
Door Safety Interlock	●	●	●	●	●
High Precision Linear Encoders	●	●	○	○	○

	UPG-500B	UPG-600C	UPG-800C	UPG-1200C	UPG-1700C
<b>Optional Configurations</b>					
High Precision 3D Probe	●	●	●	●	●
Dust Collector	●	●	●	●	●
Hand-Held Dust Collector	○	○	●	●	●
4/5th Axis Rotary Table	●	●	●	●	●
Automatic Door	●	●	○	○	○
Contact Tool Setter	●	●	●	●	●
Laser Tool Setter	●	●	●	●	●
Extended Tool Magazine	ETM-12	○	○	○	○

## Floor Plans (Unit: mm)

### UPG-500

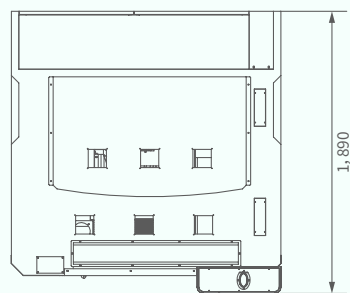
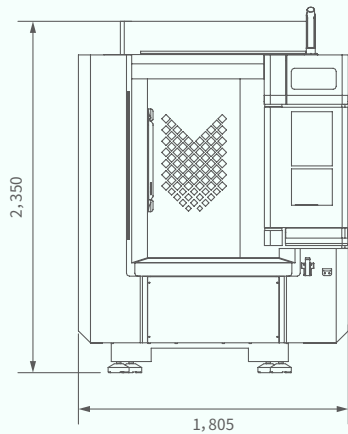

### UPG-600

